

Maintenance /Checks

1. Filters -

These are one of the most important features of the vac, if clogged they may cause considerable damage and pressure loss.

Lifespan - Pre-filter (3-4 months)
HEPA filter (12 months)

NOTE - If the Pre-filter or HEPA filter requires changing this may well cause a lack of performance.

When the filters are clogged the **RED INDICATOR LIGHT** will come on.

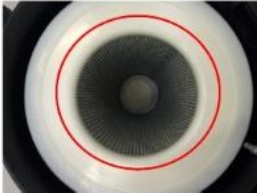

The inside of the filter is a key indicator as to whether it requires changing.

If it is dirty it will be time to change.

2. Motor -

If the motor has been capped in dust the power will be considerably lower, this may require changing the motor.

This can happen by someone mistakenly not fitting the filter correctly and dust accessing the motor.

Note - You can prevent this by fitting you filters correctly and keeping the filters clean.



When fitting the motor pack onto the cyclone, make sure the HEPA filters stays in place. **As highlighted**

If you knock it out of place dust will access your motor and damage its running gears.

This may well be why your previous motor was damaged.

3. Cleaning/moisture -

The filters are not to be cleaned with water or immersed in any depth or water.

If water has accessed the cyclone during cleaning the vac or hoovering, any moisture may well have damaged the important electrical circuits.

NOTE - do not use the unit to suck up wet material, this will only clog your filters and damage the motor.



Your HEPA Filters should look like this throughout most of its life.

NOTE - The fitment of the HEPA is very important, make sure it is pushed in and doesn't come loose when attaching the cyclone.

4. Outlet/exhaust -

The outlet should always be covered by the rear exhaust. This will prevent the issue you were previously having before your unit was returned.

INCORRECT

The outlet is the hole highlighted in the image.

When your unit was returned it looked like this. This is why it was spewing out all the waste.

Make sure the outlet is facing the other way behind the exhaust.



CORRECT

Your unit should like this.

The power switch should be facing the user.

5. Reverse pulse -

The reverse pulse is another critical check. It clears your filters and prolongs their lifespan.

Make sure this operation is done after every use.

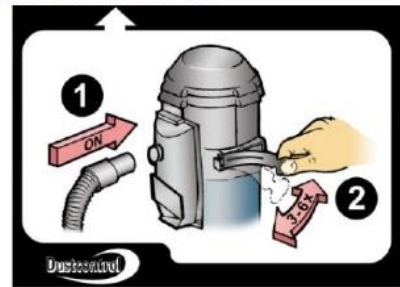

6. Cable -

If the cable has mistakenly been pulled too hard or pinched in the bin/cyclone during the emptying process, this may cause power supply damage.

Again if the cable is wrapped around the motor pack after using the vac, this could also loosen the connection.

NOTE - In general you will be getting power but it will very temperamental (cutting out).

7. Brushes -

The motor is a brushed motor, if the brushes have been completely worn down your motor will cease to operate.

NOTE - The brushes in general will last between 12-24 months, relative to usage.

8. Drop -

If the unit has accidently been dropped by anyone or fallen over in transit this may have damaged the motor.